

 启明幕墙门窗
HOMI QIMING WINDOOR AND CURTAIN WALL





HOMI

Miracle the Architecture

Windows & DoorsSystem

We have provided high-quality doors, windows, and curtain wall products to more than 20 countries and regions worldwide.



● **HA38 TRACK-HIDDEN SLIMLINE SLIDING DOOR**



Glass Options	Suitable Width/Height	Visible Width/Height (mm)
---------------	-----------------------	---------------------------

DGU:30-38mm	Width 1000-3000 mm Sash height 1800-3000mm Weight 400kg(MAX)	Frame Width 50mm Visible Sash Width 38mm Visible sash width 20.6mm
-------------	--	--

Watertight Performance (Pa)	Airtight Performance	Wind Load Resistance (KPA)
-----------------------------	----------------------	----------------------------

500PA level 5	level 6	4.0KPA level 7
------------------	---------	-------------------

● HA38 SLIM SLIDING DOOR



Glass Options	Suitable Width/Height	Visible Width/Height (mm)
DGU:30-38mm	Width 1000-3000 mm Sash height 1800-3000mm Weight 400kg(MAX)	Frame Width 50mm Visible Sash Width 38mm Visible sash width 20.6mm
Watertight Performance (Pa)	Airtight Performance	Wind Load Resistance (KPA)
500PA level 5	level 6	4.0KPA level 7

● **HW100 CASEMENT WINDOW**



Glass Options	Suitable Width/Height	Visible Width/Height (mm)
SGU 4-10mm DGU 16-24mm	sash width 300-800mm sash height 300-1800mm loading bearing ≤45KG	Frame&sash visible width(outside) 96mm; Frame profile depth 100mm
Watertight Performance (Pa)	Airtight Performance	Wind Load Resistance (KPA)
500PA level 5	level 6	4.1KPA level 7

● **HD125 HINGED DOOR**



Glass Options	Suitable Width/Height	Visible Width/Height (mm)
Single glass Doubl SGU 5-10mm DGU19-24mm (normal)	sash width 300-800mm sash height 300-1800mm loading bearing≤45KG	Frame&sash visible width(outside) 120mm; Frame profile depth 125mm
Watertight Performance (Pa)	Airtight Performance	Wind Load Resistance (KPA)
500PA level 5	level 5	4.1KPA level 7

● **HFD83 FOLDING DOOR**



Glass Options	Suitable Width/Height	Visible Width/Height (mm)
---------------	-----------------------	---------------------------

SGU 6-10
DGU 19-36

sash width 600-1100mm
sash height 1920-5000mm
loading bearing ≤150KG
(1 panel)

Meeting stile 180mm;
Frame profile depth 92mm

Watertight Performance (Pa)	Airtight Performance	Wind Load Resistance (KPA)
-----------------------------	----------------------	----------------------------

500PA
level 5

level 5

4.1KPA
level 7

● **HSD150 SLIDING DOOR**



Glass Options	Suitable Width/Height	Visible Width/Height (mm)
SGU 6-10 DGU 19-24	sash width 720-3300mm sash height 1800-2700mm loading bearings≤300KG	Meeting stile 100mm; Frame profile depth 113mm
Watertight Performance (Pa)	Airtight Performance	Wind Load Resistance (KPA)
500PA level 5	level 6	4.1KPA level 7

- **135 SERIES NON THERMAL-BREAK UNITIZED CURTAIN WALL**



Glass Thickness (mm)	Unitized Width/Height (mm)	Visible Width (mm)
----------------------	----------------------------	--------------------

DGU 24-38

Width 1000-1500mm
Height 2000-3500mm

Invisible

Water Tightness (Pa)	Air Tightness	Wind Load(KPA)
----------------------	---------------	----------------

based on elevation

based on elevation

2.5-4.8
level 7
based on 1.5m(W)*3.0m(H)

● **HSD190 LIFT&SLIDING DOOR**



Glass Options	Suitable Width/Height	Visible Width/Height (mm)
---------------	-----------------------	---------------------------

DGU 19-36	sash width 500-1600mm sash height 1200-2700mm loading bearing≤150KG	Meeting stile 100mm; Frame profile depth 127/187mm
-----------	---	--

Watertight Performance (Pa)	Airtight Performance	Wind Load Resistance (KPA)
-----------------------------	----------------------	----------------------------

500PA level 5	level 6	3.1KPA level 5
------------------	---------	-------------------

Thermal break profiles

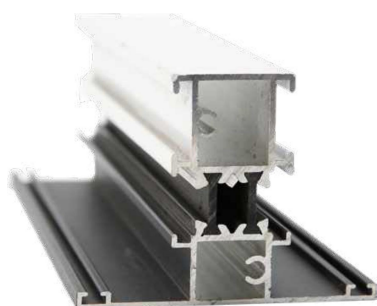

Curtains wall profiles

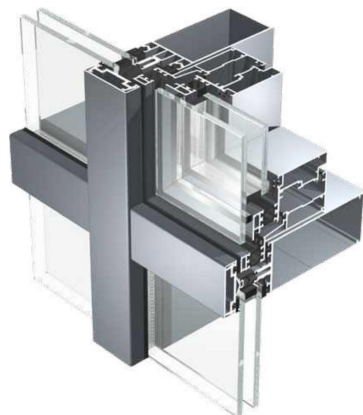
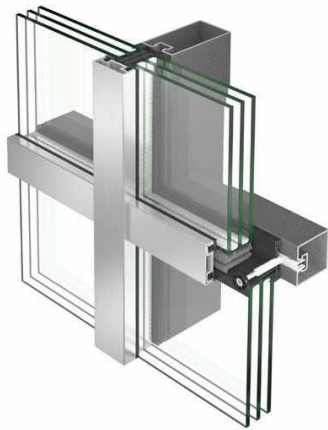
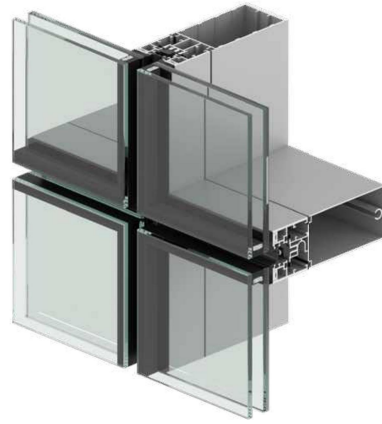



Details



Meticulously Crafting Every Detail



SLIDING DOOR



FOLDING DOOR



CASEMENT WINDOW



CASEMENT DOOR



Curtain walls blend aesthetic beauty with practicality, enhancing urban landscapes and creating comfortable environments by seamlessly integrating artistry and functionality in architecture.

Curtain Wall

The presence of curtain walls allows buildings to exhibit a unique aesthetic and modern ambiance. Through meticulously designed exterior materials and structures, they add brilliance to the city while providing excellent insulation, soundproofing, and lighting effects. This enhances the indoor environment, making it more comfortable and meeting people's pursuit of beauty and functionality.



Office Partition

Leading processing equipment & exquisite product design create high-end, energy-saving product series.



Office Partition Advantages

1. excellent fire resistance performance—up to 120 minutes

2. Unique style—Featuring distinctive door sashes, locks, and hinges; the appearance is aesthetically neat and tidy.

3. Easy installation—fast installation design, saves time & labor cost.

4. Precise positioning—High-precision aluminium spacing can achieve consistent module spacing without any deviation, ensuring constant beauty and quality of the lines.



List of Factory Equipment

Device name	Quantity unit	Equipment origin	Remark
MH3248*60T Hydraulic Cold Press Machine	1 unit	China-Taiwan	Used for panel/-door leaf forming
Hydraulic Guillotine Shear Machine	1 unit	China-Anhui Zhonghuan Machine Tool	Used for full steel partition production equipment
Hydraulic Plate Bending Machine	1 unit	China-Anhui Zhonghuan Machine Tool	Used for full steel partition production equipment
Open Type Tilt Press Machine	1 unit	China-Shenyang	Used for panel processing equipment
MJ61 Precision Push Bench Saw	1 unit	China-Shenyang	Used for panel processing equipment
High-Speed Automatic Saw Cutting Machine	1 unit	China-Shenyang	Used for aluminum material processing equipment
MJ-350 Precision 45 Degree Bevel Cutting Machine	1 unit	China-Taiwan	Used for aluminum material processing equipment
Punch Press Machine	10 unit	China-Guangdong	Used for aluminum material processing equipment
Aluminum Profile Cutting Machine	1 unit	China-Guangdong	Used for aluminum material processing equipment
Stainless Steel Skirting Line Roll Forming Machine	1 unit	China-Guangdong	Used for full steel partition production equipment

Single Side Keel Roll Forming Machine	1 unit	China-Guangdong	Used for full steel partition production equipment
Full Steel Top and Bottom Chapper Roll Forming Machine	1 unit	China-Guangdong	Used for full steel partition production equipment
Steel Keel Roll Forming Machine	1 unit	China-Guangdong	Used for full steel partition production equipment
Steel Frame Glass Door Roll Forming Machine	1 unit	China-Guangdong	Used for full steel partition production equipment
Aluminum Profile CNC Drilling and Milling Precision Sawing Machine	1 unit	China-Guangdong	Used for aluminum material processing equipment
Aluminum Profile CNC Double Angle Cutting Sawing Machine	1 unit	China-Guangdong	Used for aluminum material processing equipment
CNC Bending Machine	1 unit	China-Jiangsu	Used for metal panel processing equipment
Hydro-Electric Hybrid Bending Machine	1 unit	China-Jiangsu	Used for metal panel processing equipment
CNC Servo Turret Punching Machine	1 unit	China-Jiangsu	Used for metal panel processing equipment
Multi-Axis Robotic Manipulator	1 unit	China-Jiangsu	Used for metal panel processing equipment

Tesa---Double Glass Office Partition System



- The Tesa partition system is Steel-aluminum combined system(Galvanized Steel as interior vertical/horizontal keel, while the aluminium as the exterior cladding & decoration frame).
- Powder coating, anodizing available for aluminium.
- Kinds of decoration partition panel & glass panel optional

Parameters

Partition Type Tesa--steel-aluminium combined system

Specification Partition thickness 100mm; Top/bottom rail height:20mm; glass panel frame width 20mm;Module spacing: 4mm Max height:4.5m

Panel type Double 6mm/ 8mm/10mm tempered glasses

Tape Color Black/White/Grey

Shock Resistance 500Nm

Sound insulation 45dB-50dB

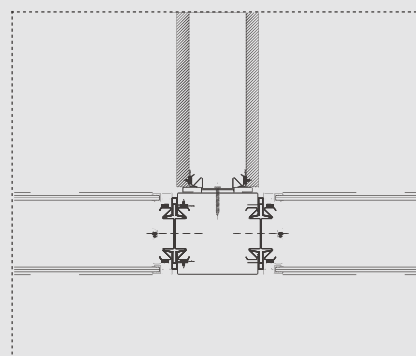
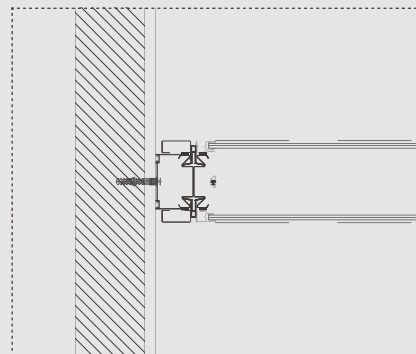
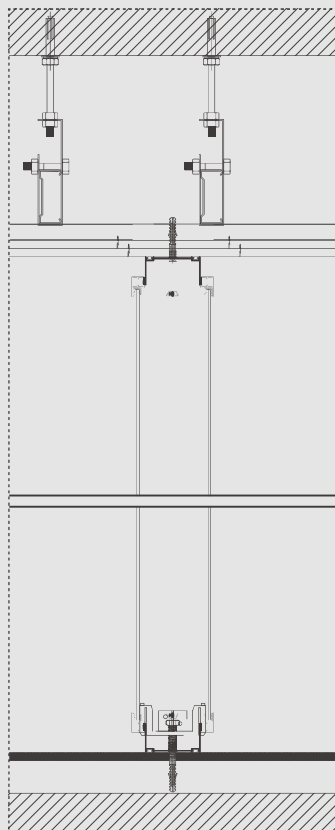

Panoramic Office Partition System



- The panoramic partition system is made of aluminum structure (with steel reinforcement at door opening area); the partition frame thickness is 100mm, with aluminium alloy 6063-T5, anodizing or powder coating available.
- The interior/exterior glass can be 10/12mm clear tempered glazing from bottom up to top, butt joint with translucent acrylic spacer.

Parameters

Partition Type **Panoramic double glazed partition series**

Specification
1. aluminum partition system, 100mm width
2. Steel partition system, 1.0mm thick galvanized steel
3. Wall Thickness: 100mm, Rails High: 50mm, Modules Spacing: 3mm

Panel type
Double 12mm/10mm tempered glasses, glass to glass connection with transparent acrylic strip

Doors and Hardware
Door panel thickness: 55mm, fixed by hinge which support doors open in 180 degree, Greif (Germany brand) stainless steel lock is adopted

Partition Type **Panoramic single glazed partition series**

Specification
1. All-aluminum structure (door frames with steel and aluminum connections); Wall thickness:100mm, 90 degree right-angled splicing;
2. All-steel structure, adopting 1.0 environmentally friendly galvanized steel and electrostatic powder coating on D520 aluminum profile surface
3. Wall Thickness: 50mm, Rails High: 60mm, Modules Spacing: 3mm

Panel type
Single 12mm/10mm tempered glass, glass to glass connection with transparent acrylic strip

Doors and Hardware
Door thickness: 55mm, fixed by hinge which support doors open in 180 degree, Greif (Germany brand) stainless steel lock is adopted.

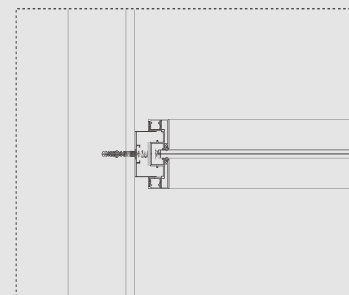
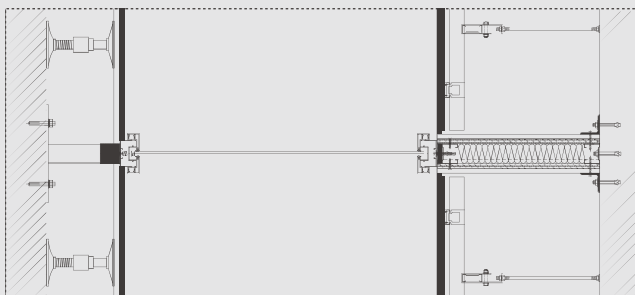

Panel Office Partition System



- The decorative boiserie system is made of steel system, framing thickness 50mm, with powder coating treatment.
- Panel is made of 1.0mm galvanized steel, with 15mm Germany gypsum board lining.
- The surface could be processed by film laminating, powder coating or wood grain heat transfer, etc.

Parameters

Specification

1. All-steel structure, wall Thickness: 50mm, 90 degree right-angled splicing;
2. All-steel structure, adopting 1.0 environmentally friendly galvanized steel and 1.0mm environmentally friendly galvanized steel plate lined with 15mm thick Knauf (Germany) gypsum board
3. Wall Thickness: 50mm, Rails High: 20mm, Modules Spacing: 4mm

Panel assembly

1. 1.0mm thick galvanized steel panel, lining with 15mm thick Knauf (Germany brand) gypsum board
2. 0.4 mm steel corrugated panel.
3. Steel panel surface treatment can be , the surface could be processed by film laminating, powder coating or wood grain heat transfer, etc.

Doors and hardware

Door thickness: 55mm, fixed by hinge which support doors open in 180 degree, Greif (Germany brand) stainless steel lock is adopted.

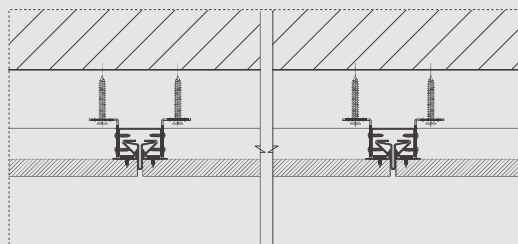
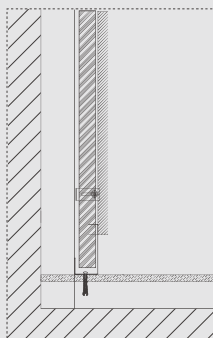
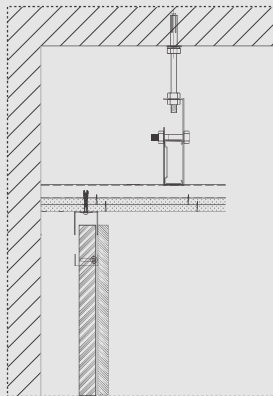



Tesa---Double Glass Office Partition System



Panoramic Office Partition System



Panel Office Partition System



HOMI

Miracle the Architecture



A10

ON-FLOOR
ALL GLASS RAILING SYSTEM

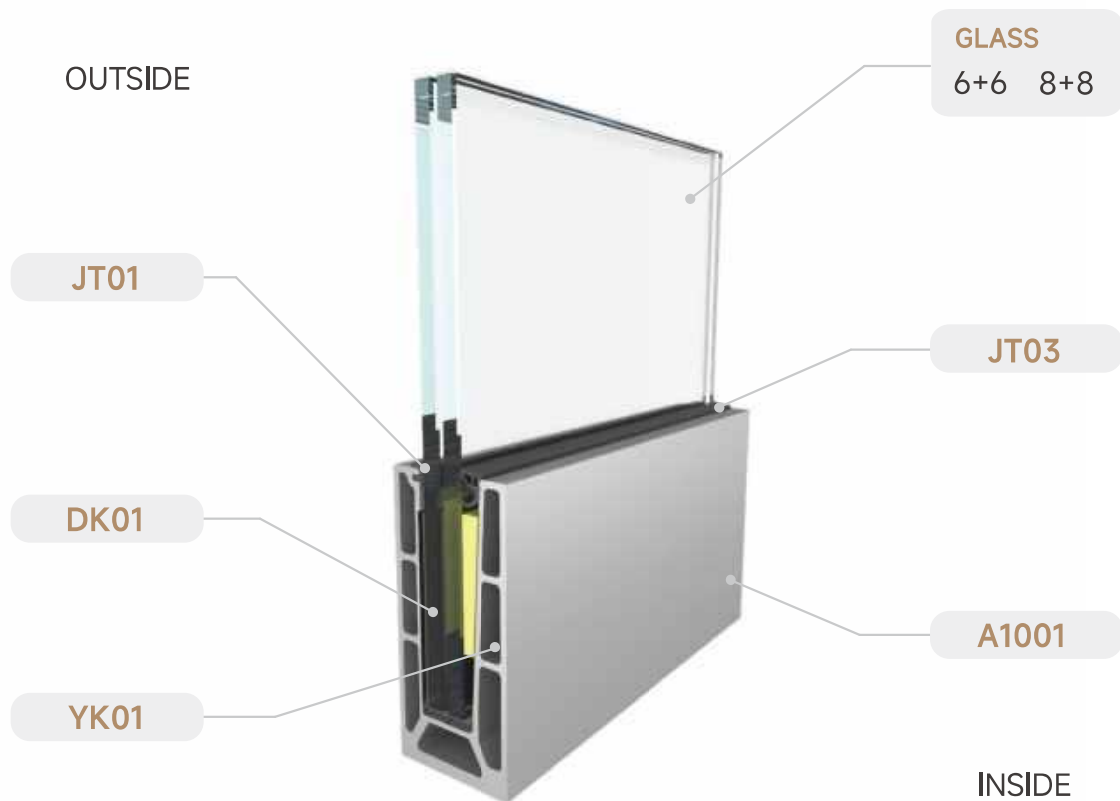

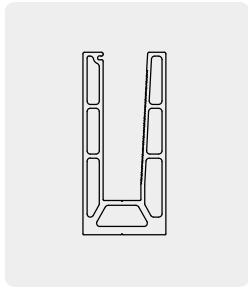

A1001
Base Profile

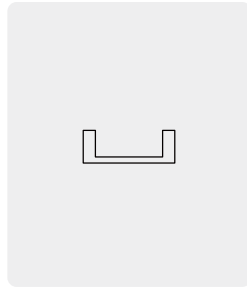

A1002
LED Strip Holder

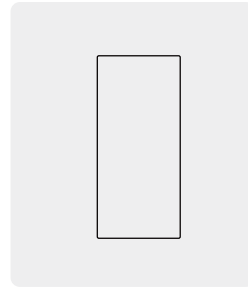

A1003
End Cap

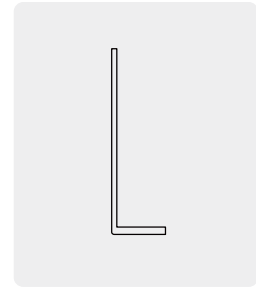

DK01
Acrylic

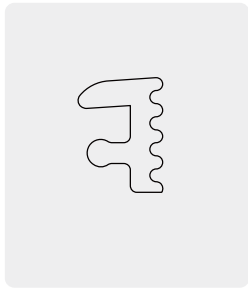

JT01
EPDM Gasket

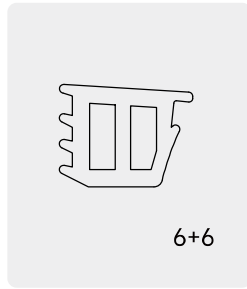

JT02
EPDM Gasket

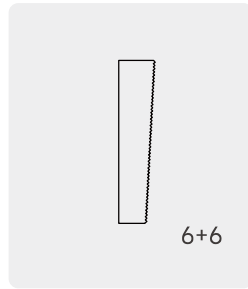

YK01
Wedge



YK02
Wedge



JT03
EPDM Gasket

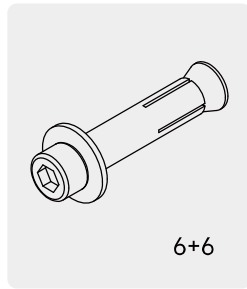

M10X100
Expansion Bolt

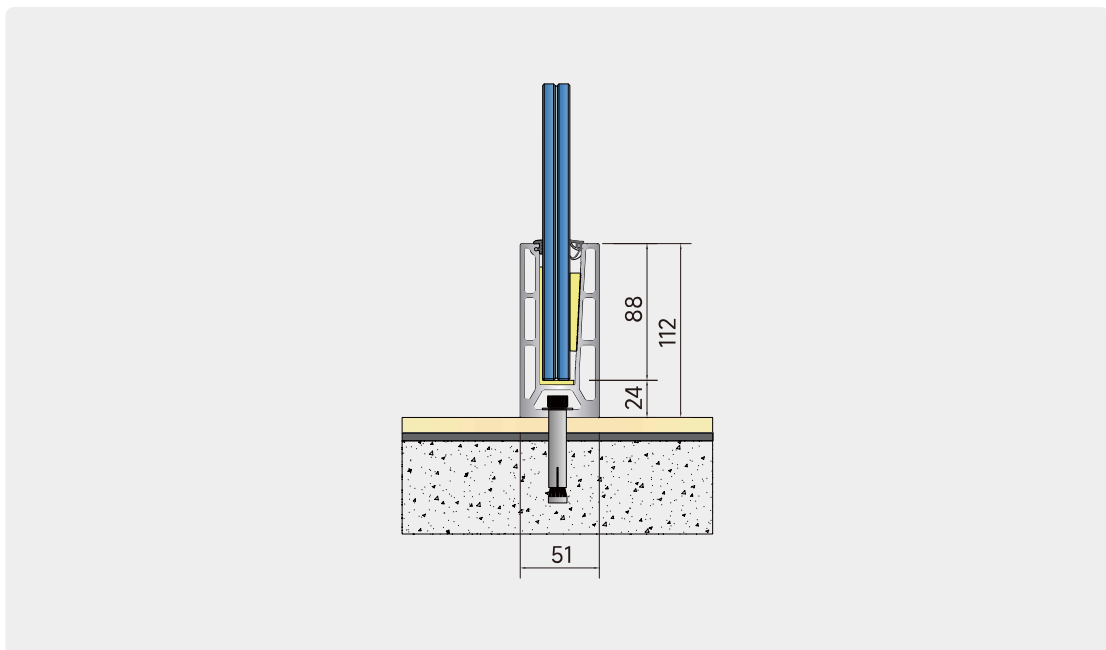

Detail

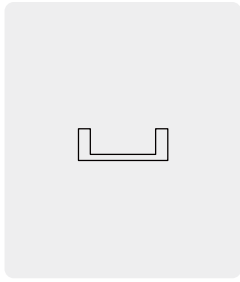

A1002
LED Strip Holder

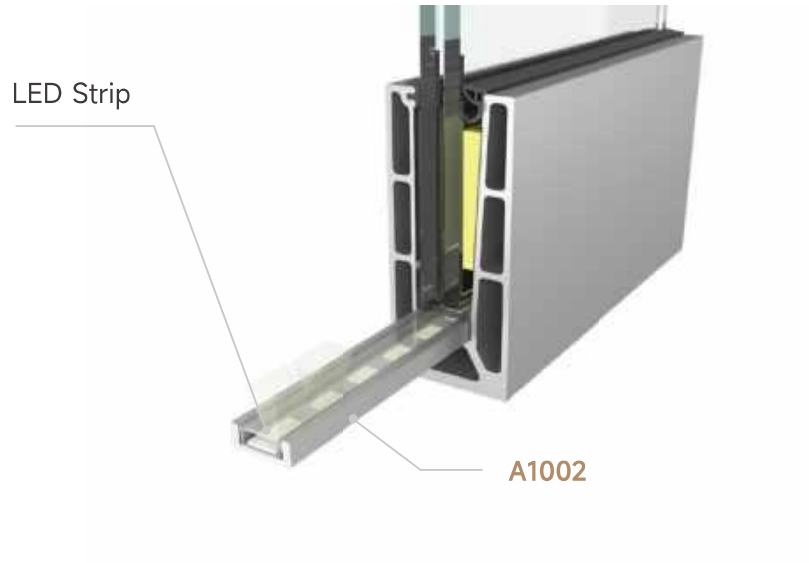

Linear Continuous Profile Installation



OUTSIDE

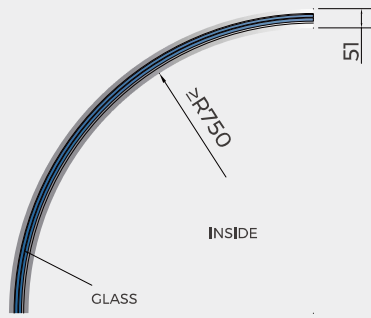

Curve radius should be bigger than 750mm

Splicing Installation Method

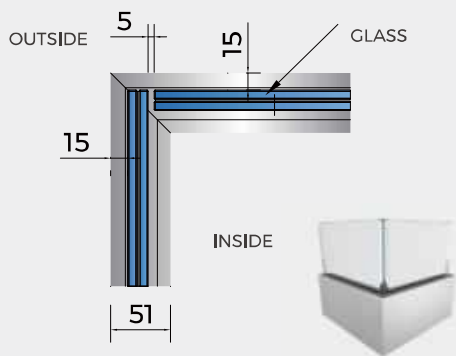

End Cap



Stair Adaptor

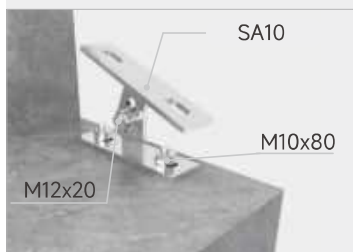

Detail of Stairway Application



Marble Stone Covering
SS/Aluminum Panel Covering



A20

ON-FLOOR
ALL GLASS RAILING SYSTEM

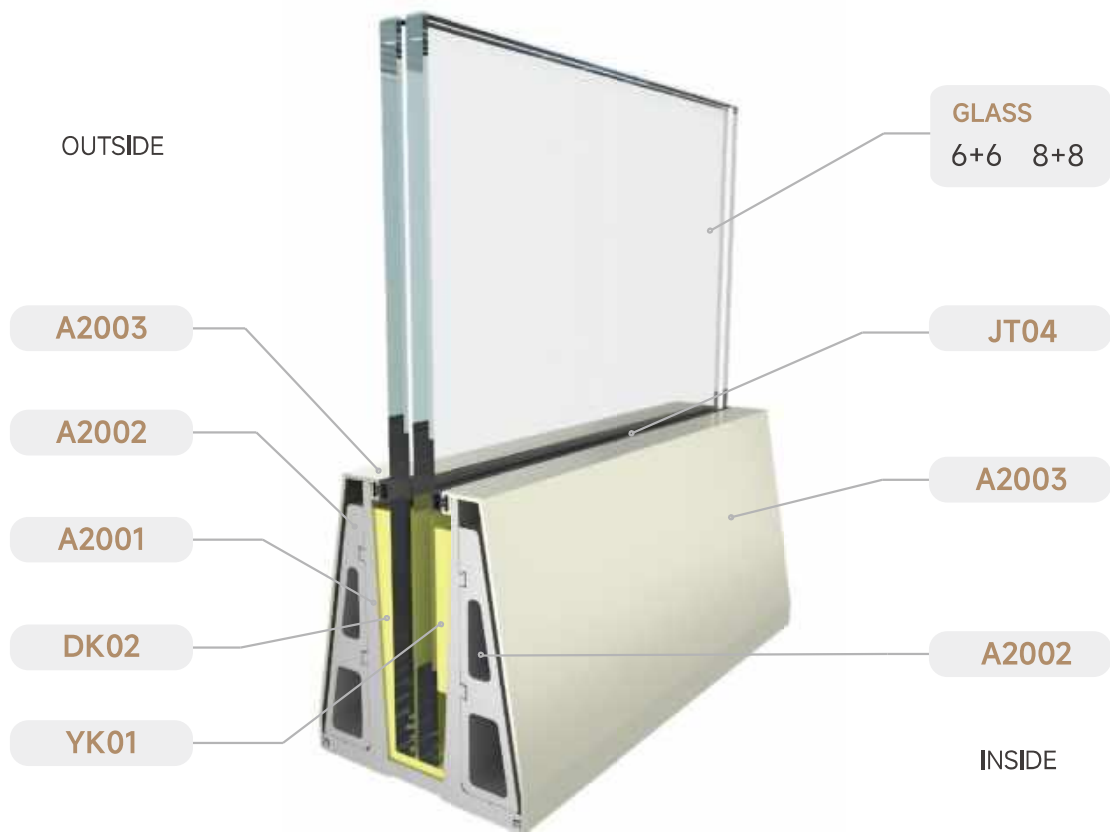

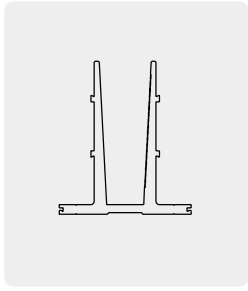

A2001
Base Profile

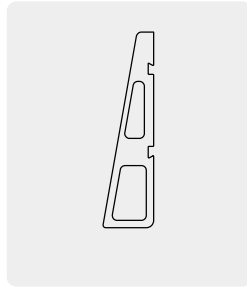

A2002
Rib Profile



A2003
Decorative Cover

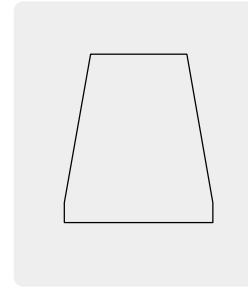

A2004
End Cap

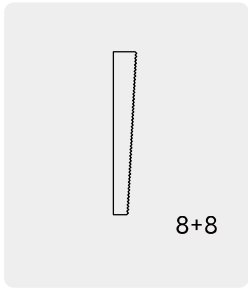

YK02
Wedge

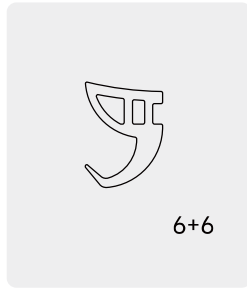

JT03
EPDM Gasket

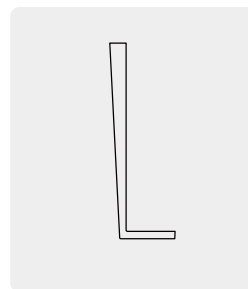

DK02
Nylon Washer

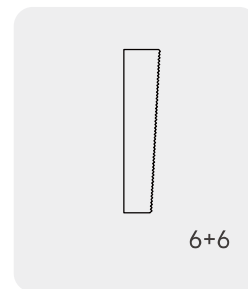

YK01
Wedge

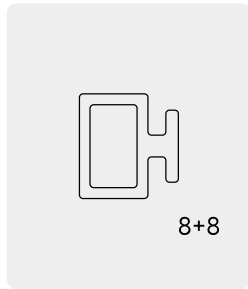

JT04
EPDM Gasket

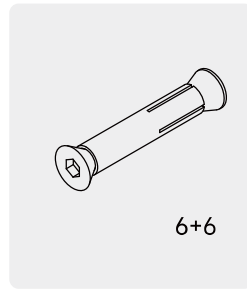

M8x100
Expansion Bolt

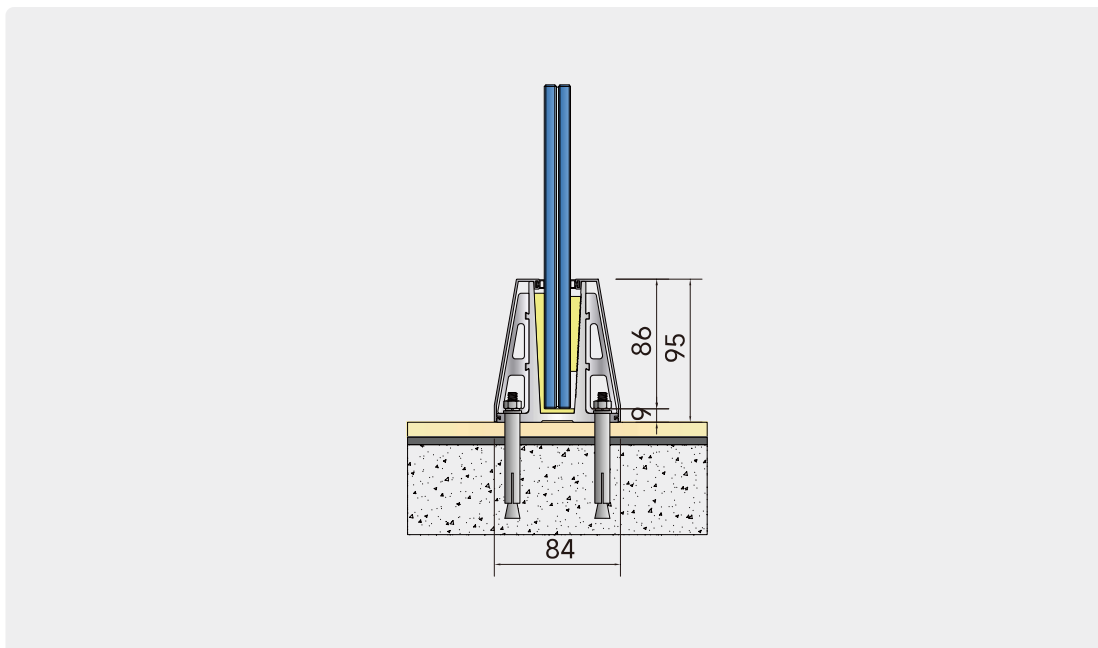

Detail

Linear Continuous Profile Installation



Splicing Installation Method

OUTSIDE

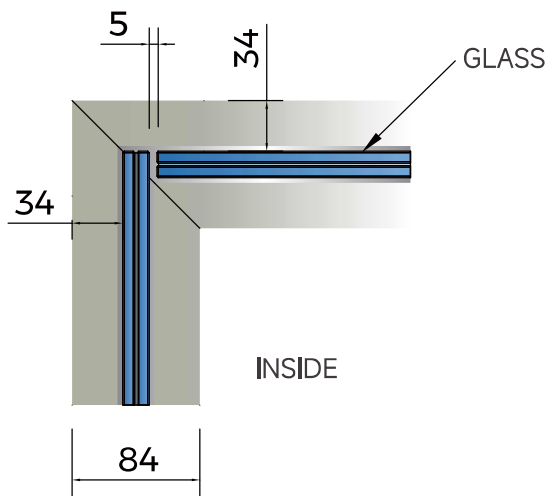

End Cap

A2004
SS/Alu Panel



A30

ON-FLOOR
ALL GLASS RAILING SYSTEM

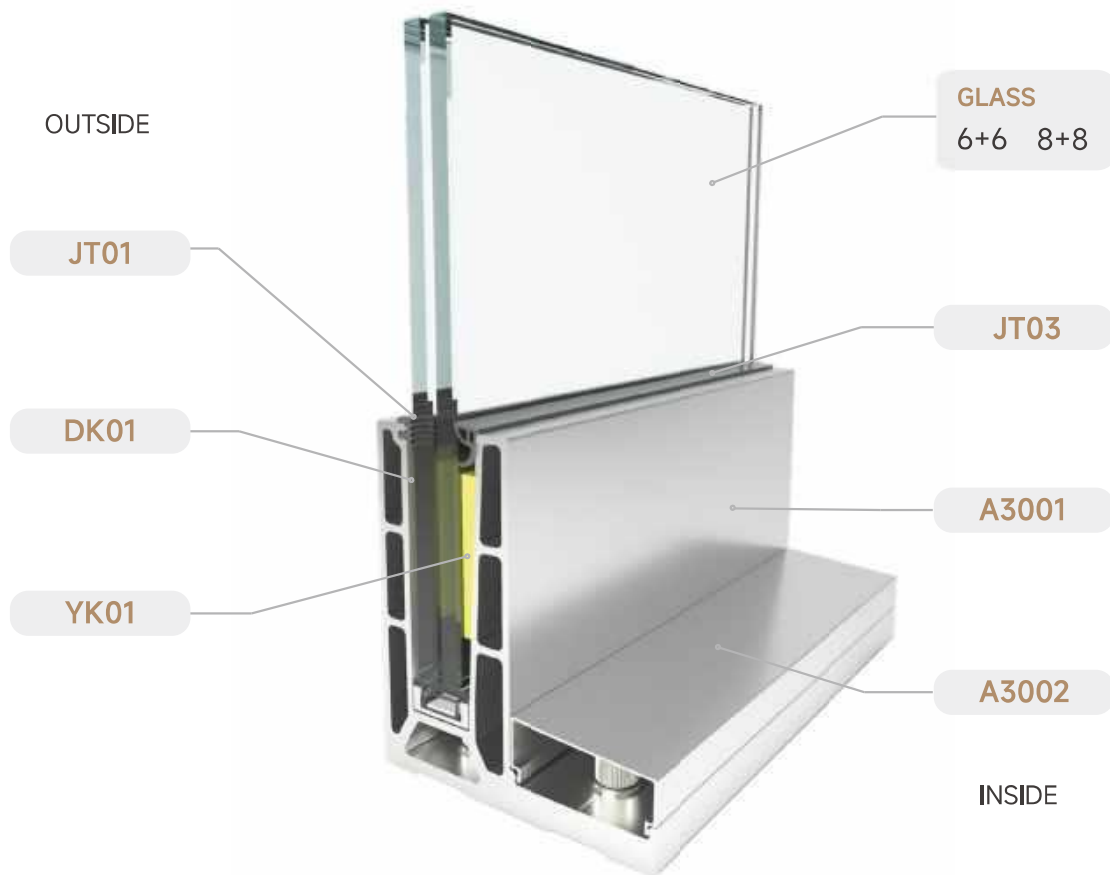

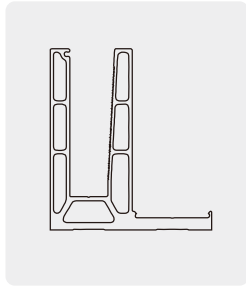

A3001
Base Profile

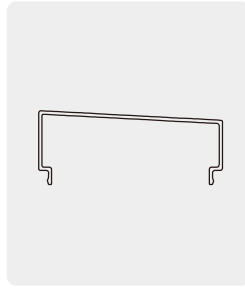

A3002
Decorative Cover

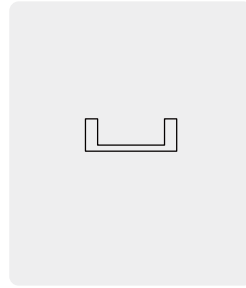

A3003
LED Strip Holder

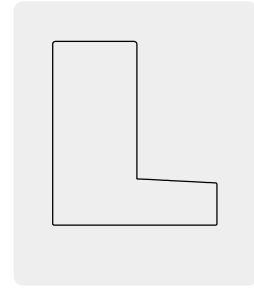

A3004
End Cap

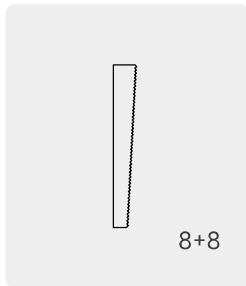

YK02
Wedge

8+8

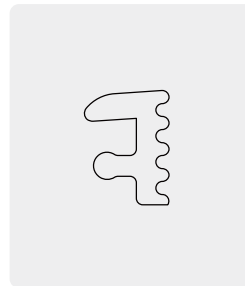

JT01
EPDM Gasket

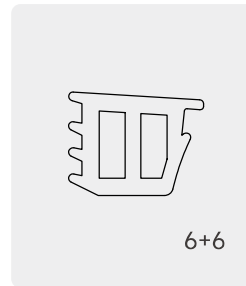

JT02
EPDM Gasket

6+6

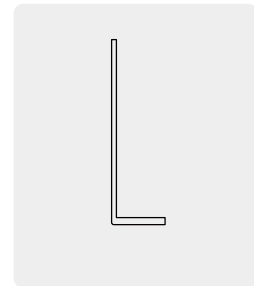

DK01
Acrylic



JT03
EPDM Gasket

8+8

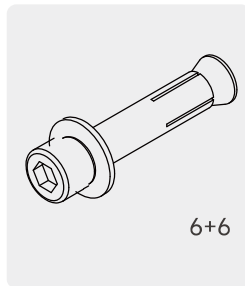

M10X100
Expansion Bolt

6+6

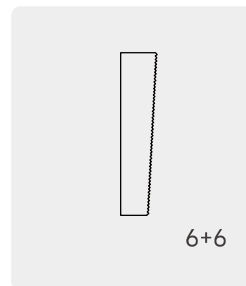

YK01
Wedge

6+6

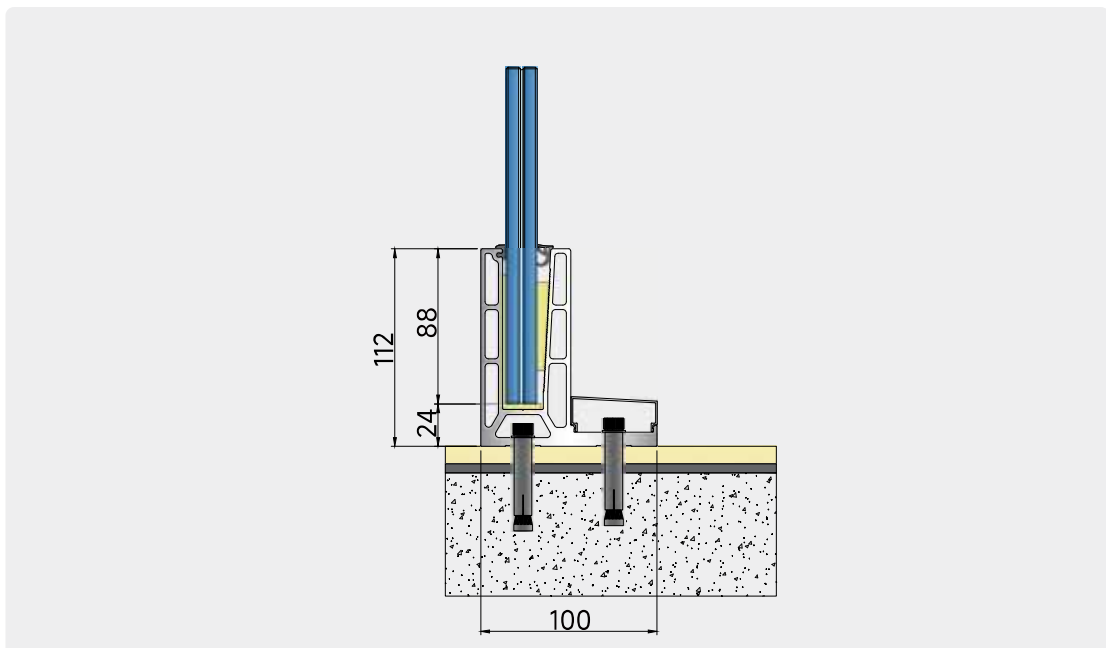

Detail

Linear Continuous Profile Installation

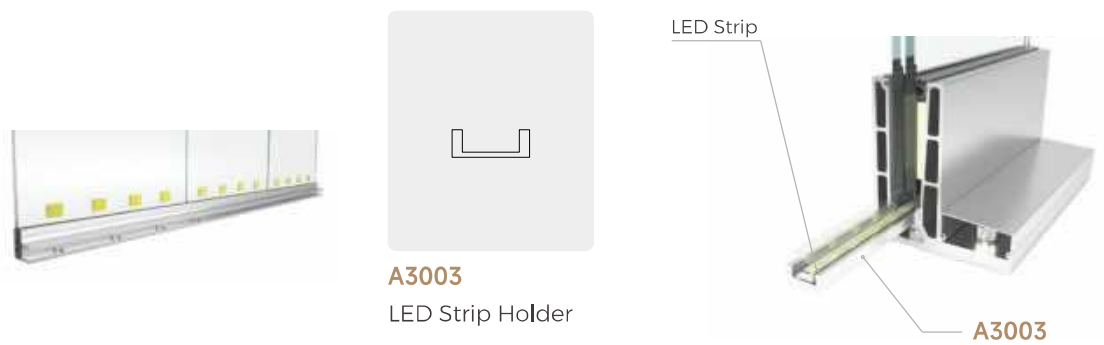

Splicing Installation Method



End Cap

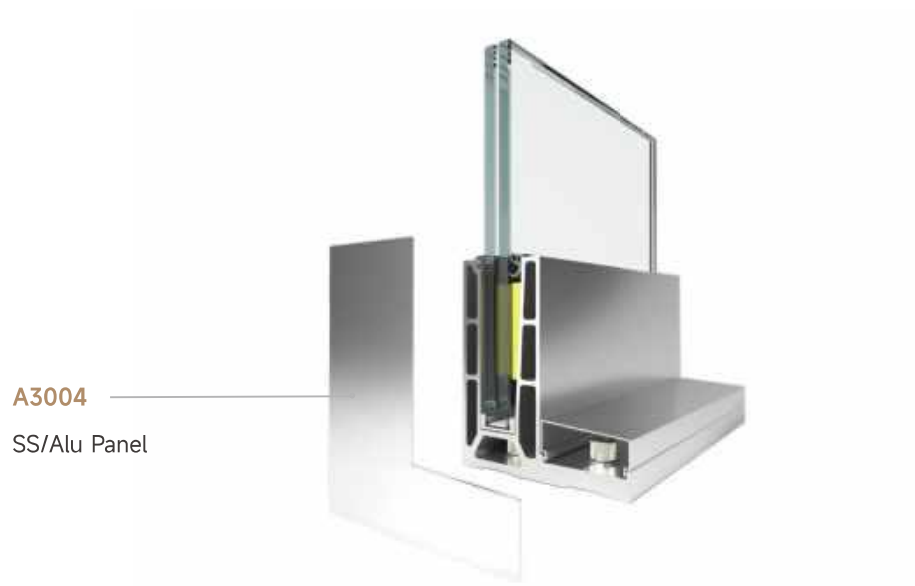

A40

ON-FLOOR

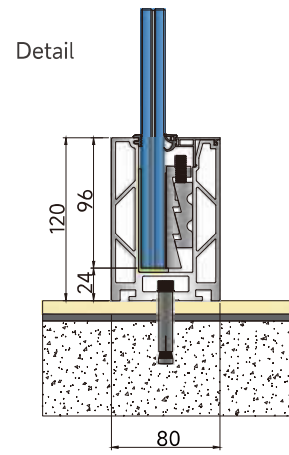

A50

ON-FLOOR

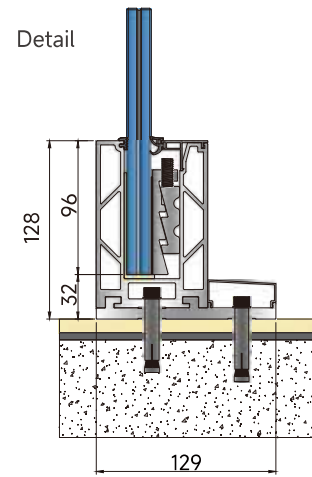

A60

ON-FLOOR

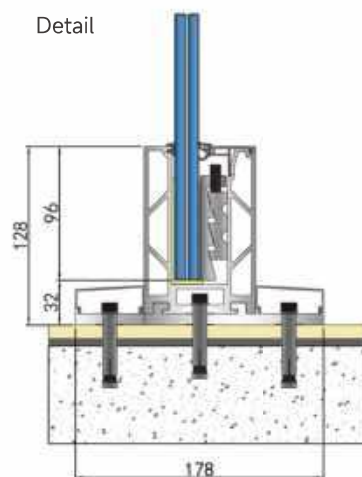

A40

ON-FLOOR
ALL GLASS RAILING SYSTEM



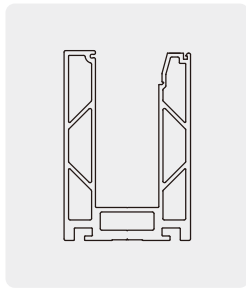

**A4001 A5001
A6001**

Base Profile

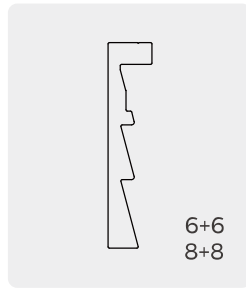

**A4002 A5002
A6002**

Adjustment Profile A1

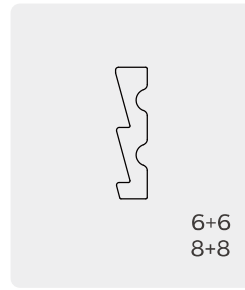

**A4003 A5003
A6003**

Decorative Cover A2

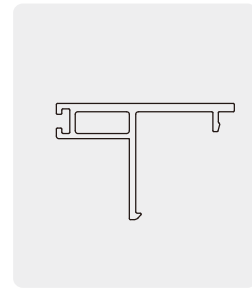

**A4004 A5004
A6004**

Decorative Cover

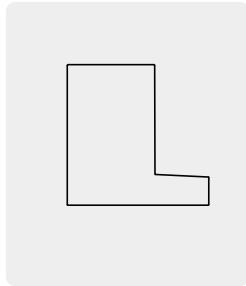

A5006

End Cap

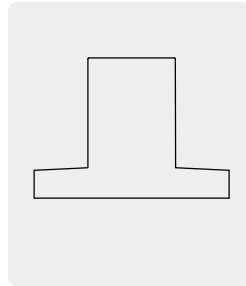

A6006

End Cap

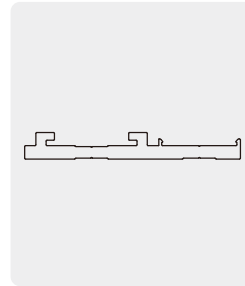

A5007 A6007

Drainage Pad

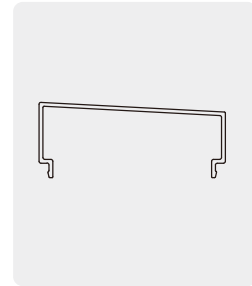

A5008 A6008

Decorative Cover



DP01

Nylon Washer

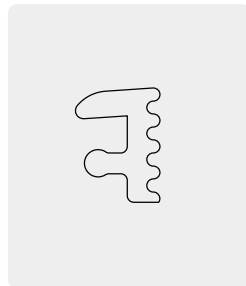

JT01

EPDM Gasket

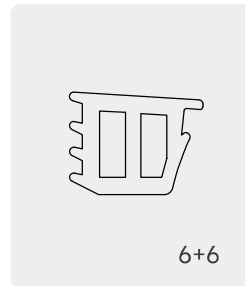

JT02

EPDM Gasket



JT03

EPDM Gasket

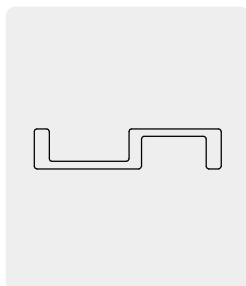

**A4005 A5005
A6005**

LED Strip Holder

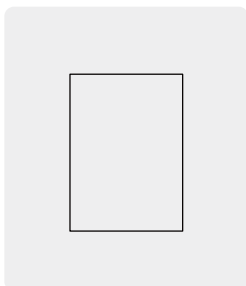

A4006

LED Strip Holder

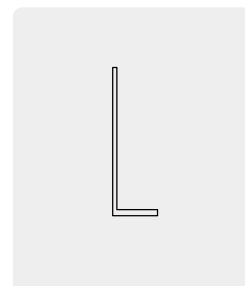

DK01

Acrylic

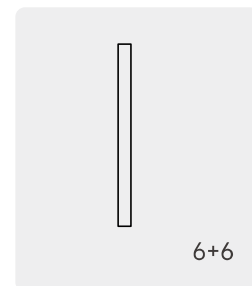

DP02

Nylon Washer

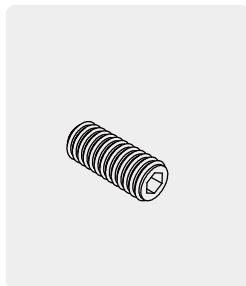

M8x20

Set Screw

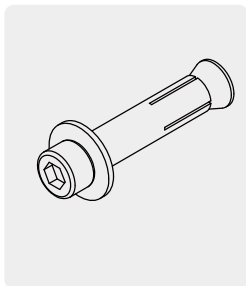

M10x100

Expansion Bolt

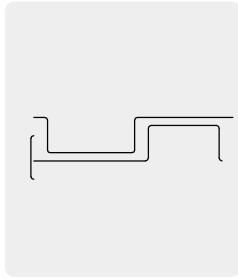

A4005
LED Strip Holder

LED Strip



Linear Continuous Profile Installation



OUTSIDE

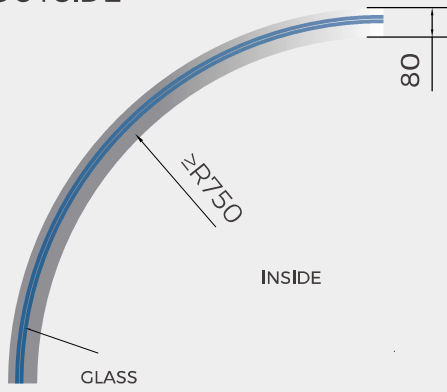

Curve radius should be bigger than 750mm

Splicing Installation Method

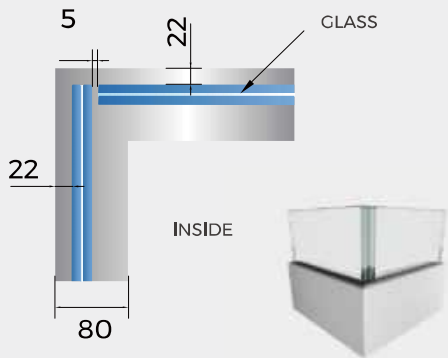

End Cap



Stainless Steel

Stair Adaptor



Detail of Stairway Application



Marble Stone Covering SS/Aluminum Panel Covering



A70

EXTERNAL
ALL GLASS RAILING SYSTEM

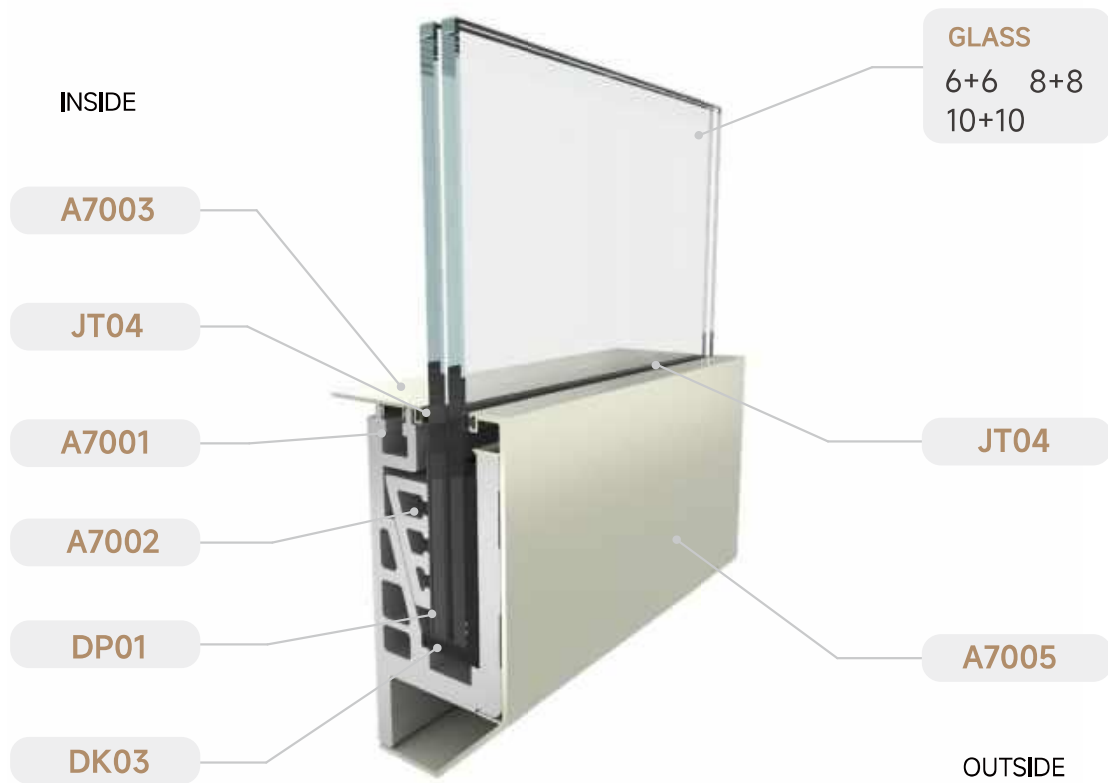

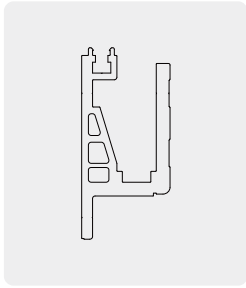

A7001
Base Profile

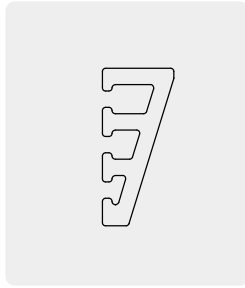

A7002
Adjustment Profile

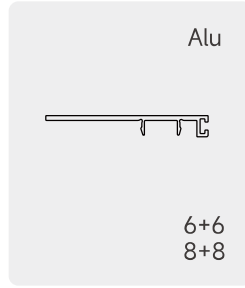

A7003
Decorative Cover

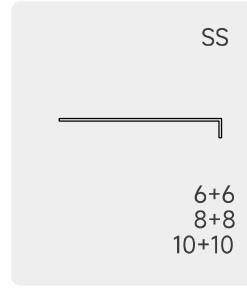

A7004
Decorative Cover

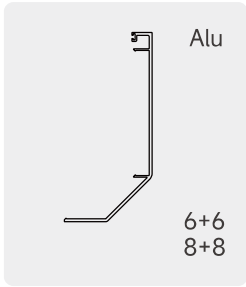

A7005
Decorative Cover

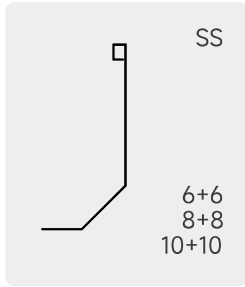

A7006
Decorative Cover

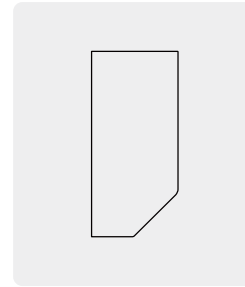

A7007
End Cap

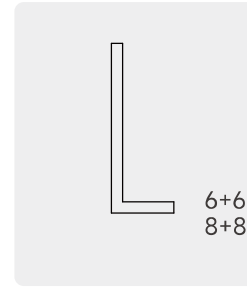

DK03
Acrylic

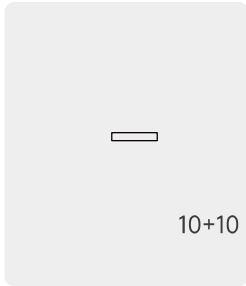

DK04
Acrylic

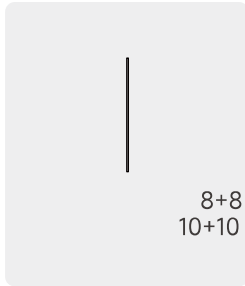

DP01
Nylon Washer

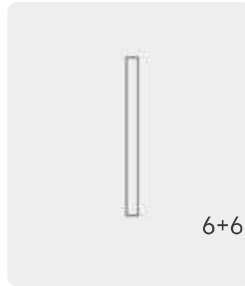

DP02
Nylon Washer

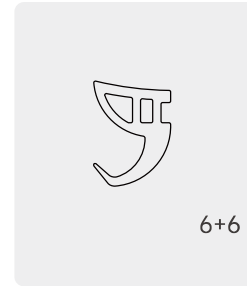

JT03
EPDM Gasket

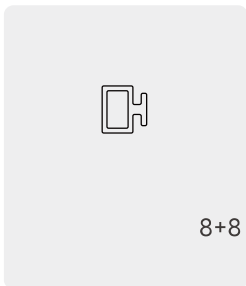

JT04
EPDM Gasket

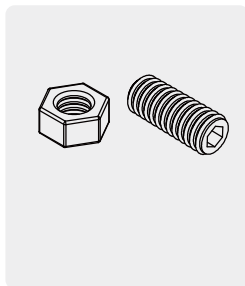

M8x20
Set Screw

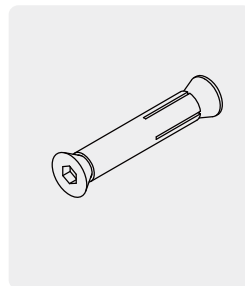

M8x100
Expansion Bolt

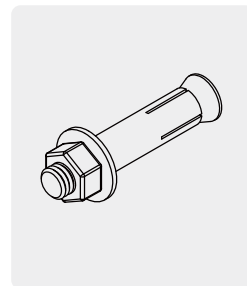

M12x100
Expansion Bolt

Detail

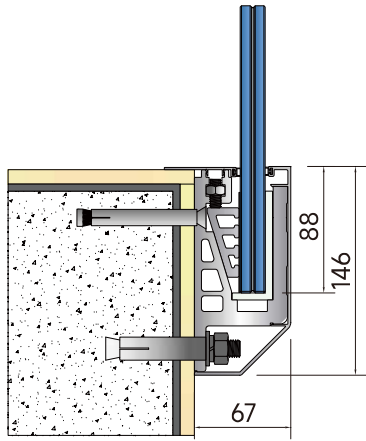

LED Strip



Linear Continuous Profile Installation



OUTSIDE

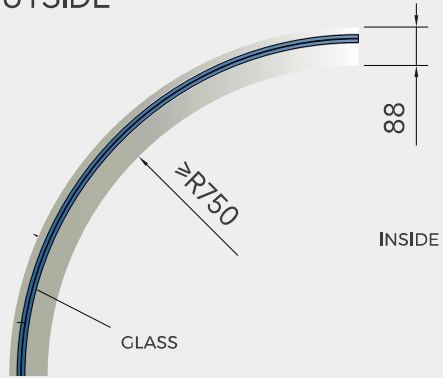

Curve radius should be bigger than 750mm

Splicing Installation Method

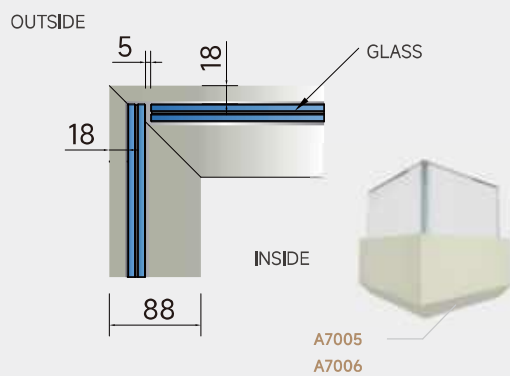

End Cap



Detail of Stairway Application



SS/Aluminum Panel Covering



A80

ON-FLOOR
ALL GLASS RAILING SYSTEM

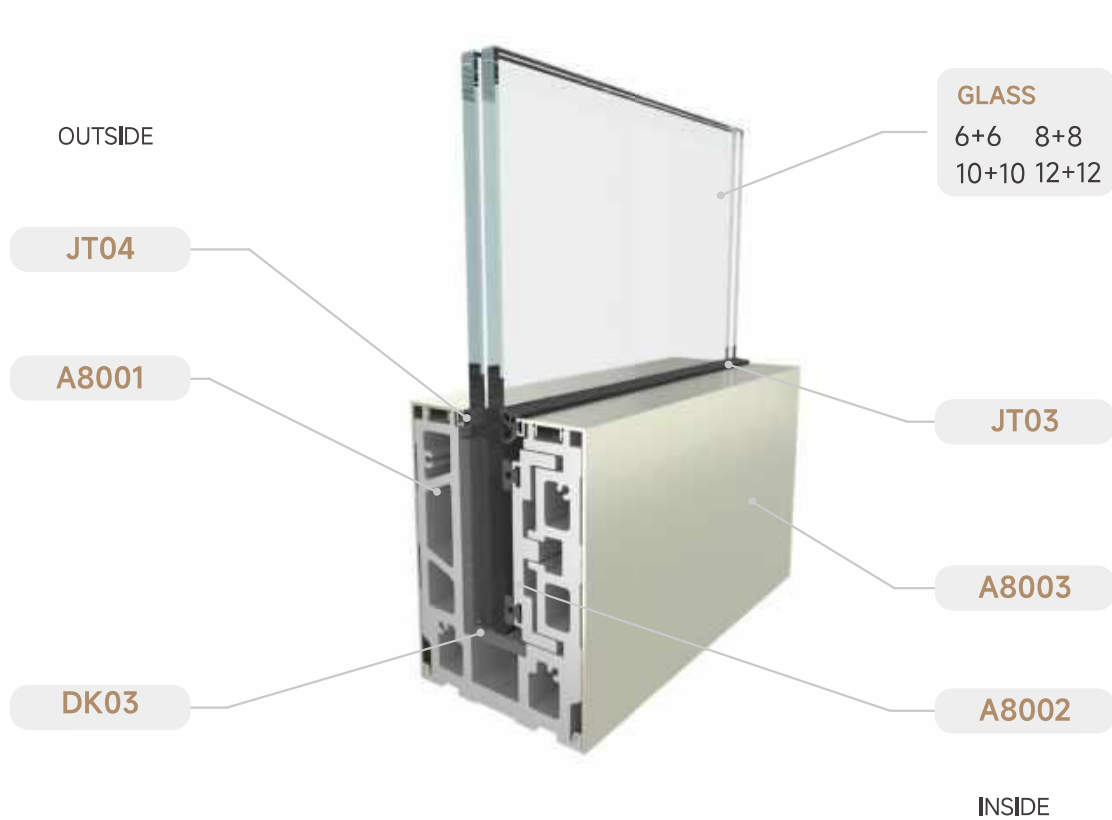

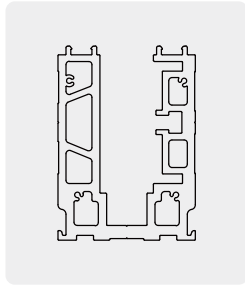

A8001
Base Profile

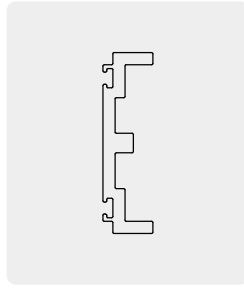

A8002
Adjustment Profile

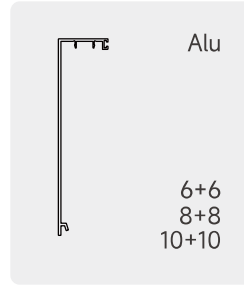

A8003
Decorative Cover

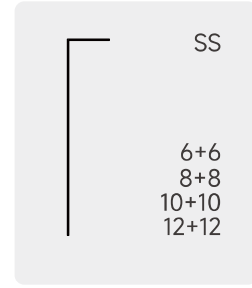

A8004
Decorative Cover

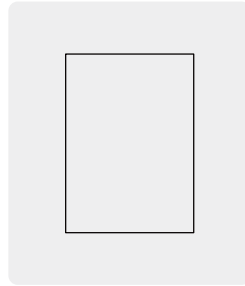

A8005
End Cap

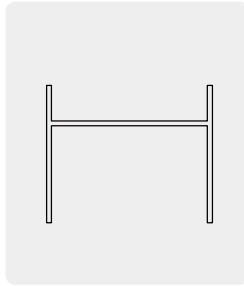

A8006
LED Strip Holder

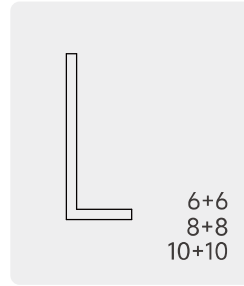

DK05
Acrylic



DK06
Acrylic

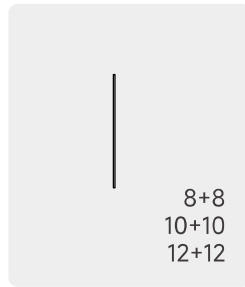

DP01
Nylon Washer

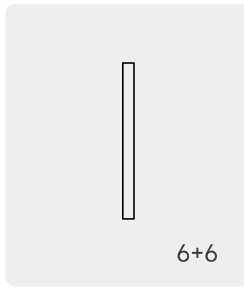

DP02
Nylon Washer

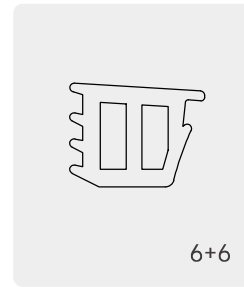

JT02
EPDM Gasket



JT03
EPDM Gasket

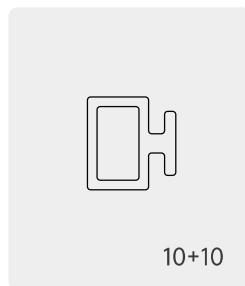

JT04
EPDM Gasket

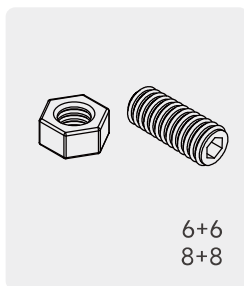

M8x20
Set Screw



M8x16
Set Screw

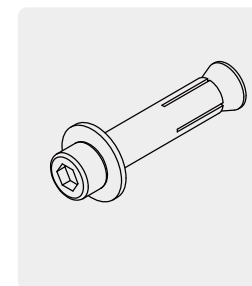

M10x100
Expansion Bolt



HOMI

Miracle the Architecture

Cases



Bank of Central African Republic

Office Partition Project Cases



2020CRDB Office Building

Choose tesa double glass series partitions,
about 2000 square meters

Doors & Windows System Project Cases



Cebu Integrated Resort



Laos Diplomatic Apartment Building



Singapore Parliament House

Residence at Tseung Kwan O Sunrise City

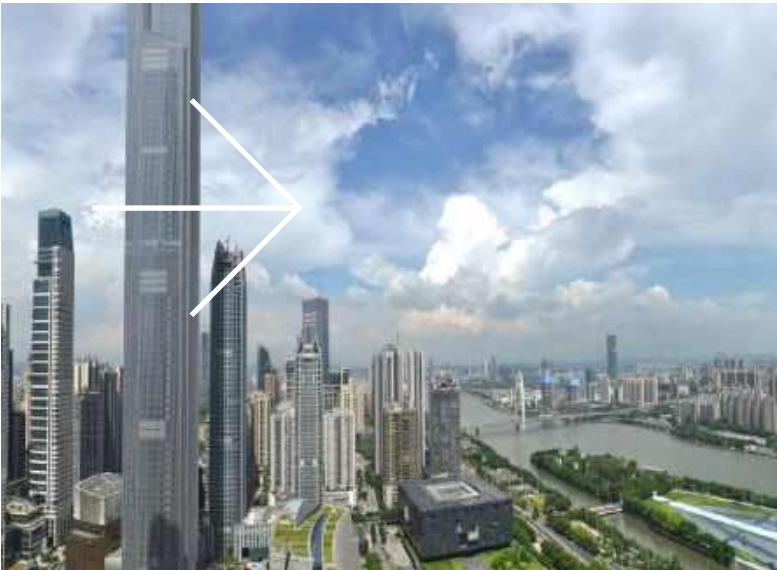

Hong Kong New World Centre

Project Cases



Pazhou Exhibition Center



Yuexiu Property Qin'ai Li Project



Apartment Building



Huizhou Olympic Garden



Dongguan Dalang Project



Philippines Project



Financial Center



South China Business College



**Guangzhou South China
Commercial Vocational College**



Zifeng Garden



Xiyue Mansion



Guiyang Century Golden Source Hotel



Auborn Lne-Australia



Reach and I-Land



Harton Corporate Center



OPUS MALL



SMDC ICE Tower



SYNC Towers



LPU Univercity



32 Sanson-Philippines



Global East Asia Medical Center



The Sapphire Bloc Ortigas Center-
Robinsons Land Residences



SM HOPE Residence



Mindhama Garden City -
Yangon Myanmar



Reach and I-Land



Harton Corporate Center



OPUS MALL



SMDC ICE Tower

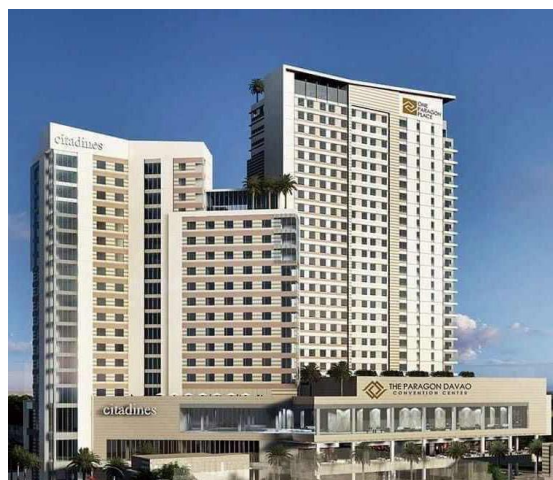

The Paragon Davao

HOMI

Keep improving

Comply with high **standard**, strive for excellence

High-Quality Doors and
Windows, Unlocking a
Beautiful Lifestyle

